

PROJECT SUMMARY: THE PURPOSE OF THIS PROJECT IS TO REPLACE THE FLOATING BREAK WATER SYSTEM THAT IS AT THE BANANA POINT BOAT LAUNCH. THE EXISTING FLOATING BREAKWATER SYSTEM CONSIST OF 24" x 95' STEEL BOOM FLOATS WITH CHAINS & ANCHORS. THE EXISTING SYSTEM IS APPROXIMATELY 30+ YEARS OLD AND ORIGINALLY CONSISTED OF 7 STEEL BOOM FLOATS. THERE ARE ONLY 4 STEEL BOOMS REMAINING (FLOATING & GROUNDED). THESE WILL BE REMOVED AND REPLACED WITH A SIMILAR SYSTEM. THE NEW FLOATING BREAKWATER WILL CONSIST OF 7 - 24" x 95' STEEL BOOM FLOATS WITH HEAVIER CHAINS & ANCHORS LOCATED IN APPROXIMATELY THE SAME LOCATION AS THE ORIGINAL FLOATING BREAKWATER.

INDEX OF SHEETS

SHEET NO.	DESCRIPTION
1.	TITLE PAGE
2.	PROPOSED OVERALL SITE PLAN
3.	STEEL BOOM FLOAT DETAILS
4.	STEEL BOOM FLOAT ANCHOR SYSTEM
5.	EXISTING STEEL BOOM FLOAT DEMOLITION PLAN

PETERSBURG BOROUGH

P.O. BOX 329, PETERSBURG, ALASKA 99833, (907) 772-4430



VICINITY MAP

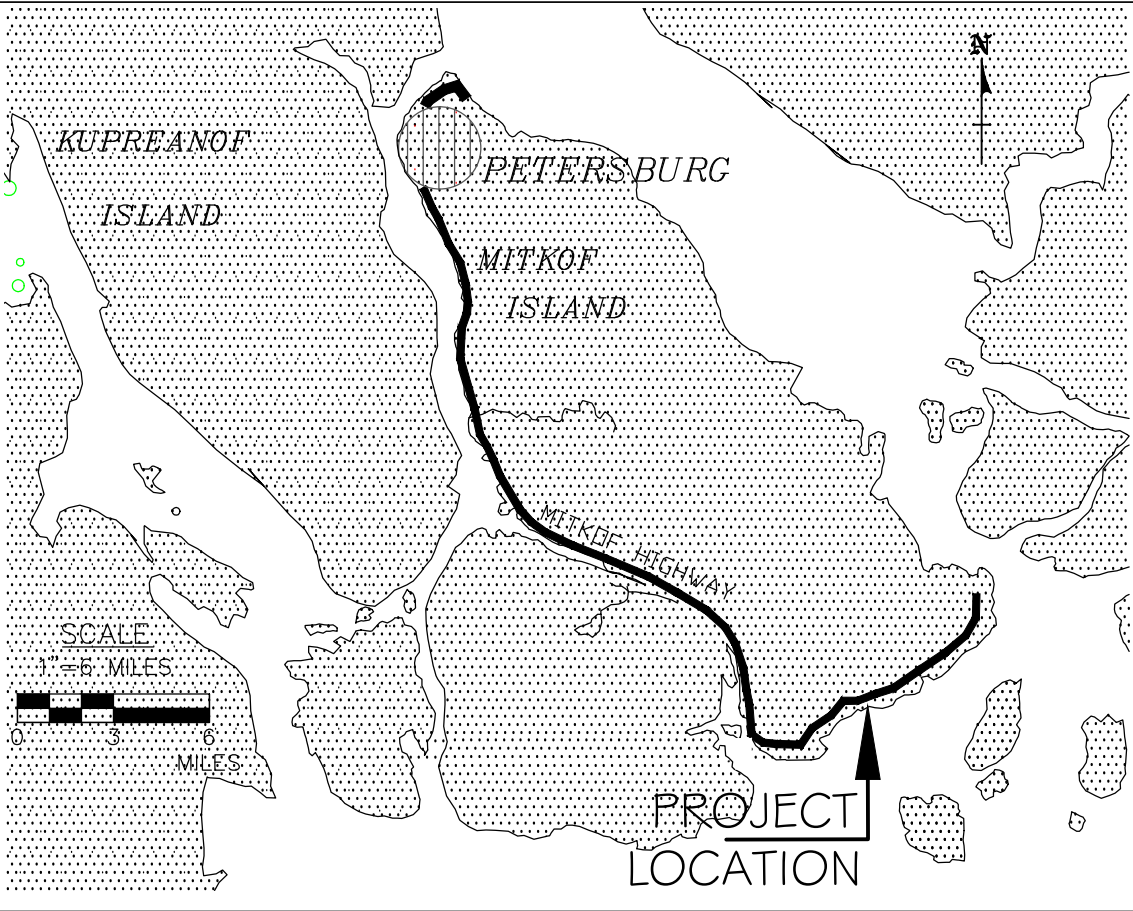

BANANA POINT
BREAKWATER
IMPROVEMENTS

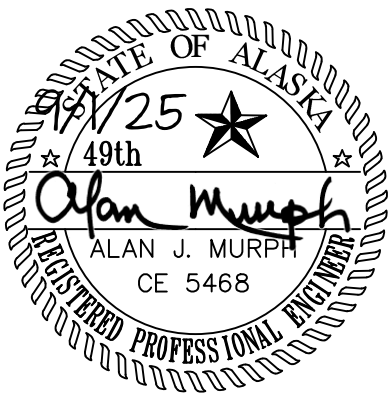

DATE: JULY, 2025

DESIGNED BY:
HARAI & ASSOCIATES, INC
P.O. BOX 625
PETERSBURG, ALASKA 99833

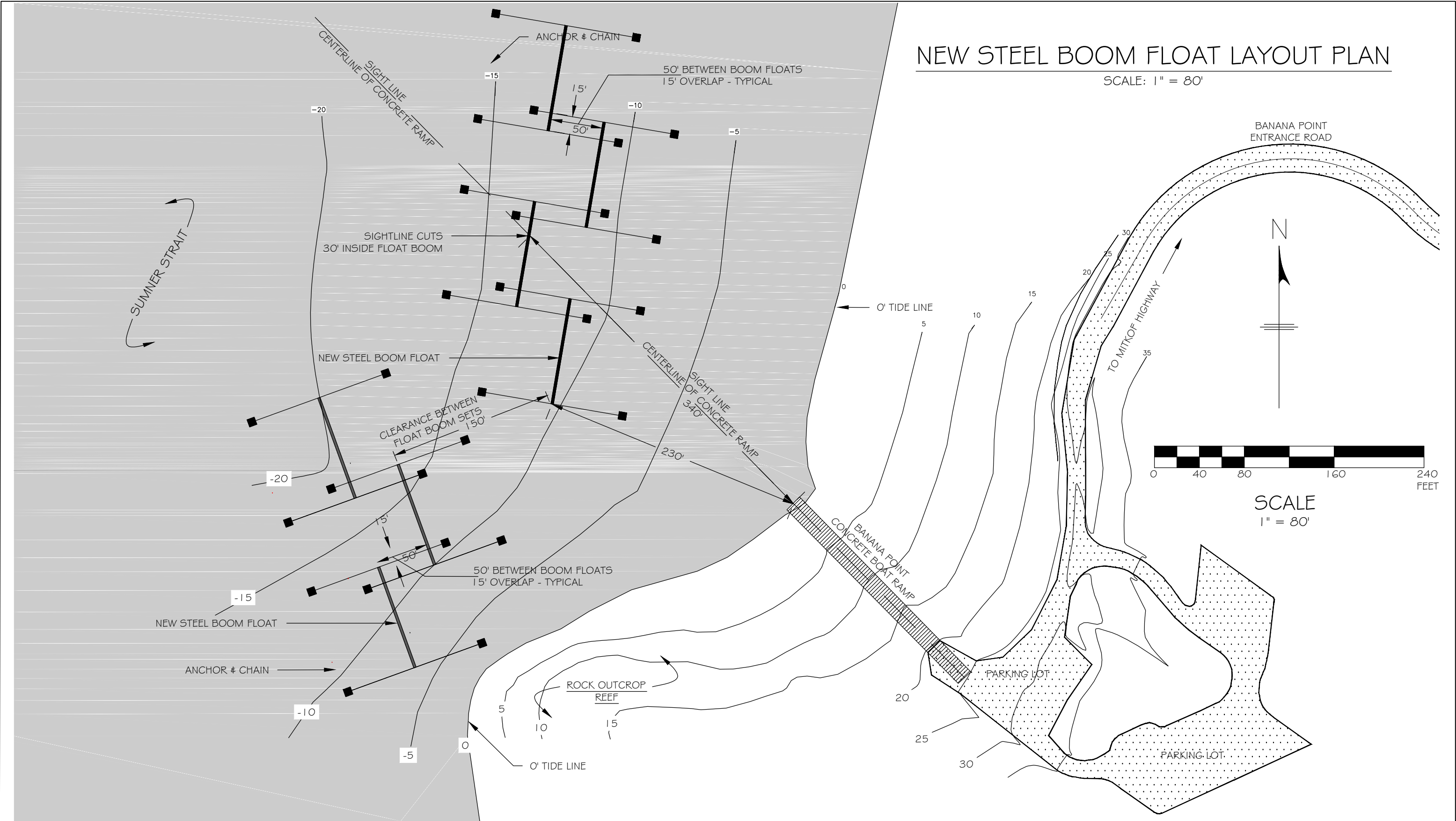

NEW
BOOM FLOAT
LAYOUT
PLAN

BANANA POINT BREAKWATER
IMPROVEMENTS

PETERSBURG BOROUGH
PETERSBURG, ALASKA

REVISIONS		
REV	DATE	DESCRIPTION

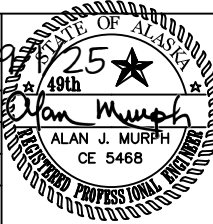

DESIGNED BY:
HARAI & ASSOCIATES, INC
P.O. BOX 625, PETERSBURG, ALASKA 99833

DATE: JULY 2025

SHEET NUMBER
2

OF 5

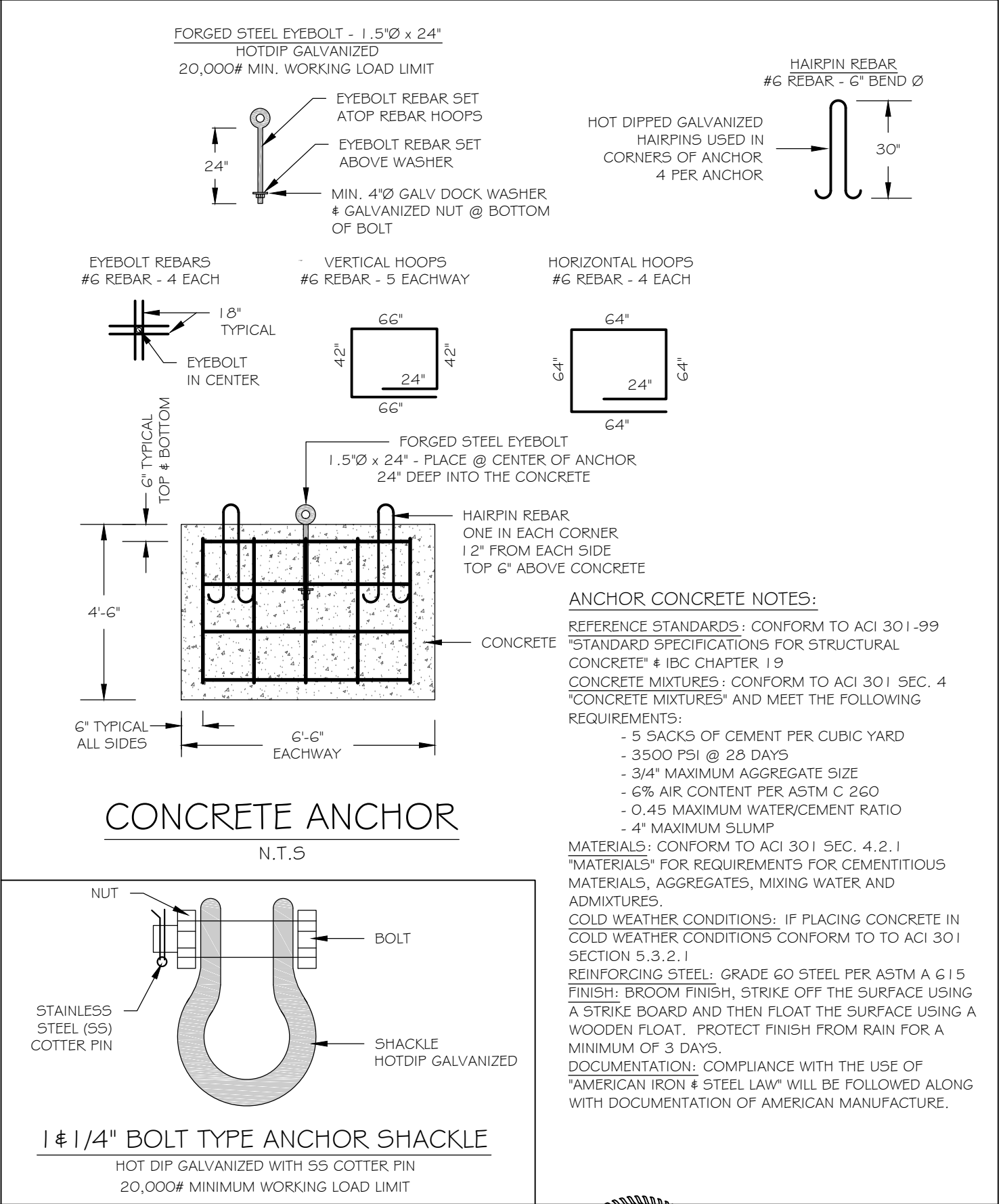
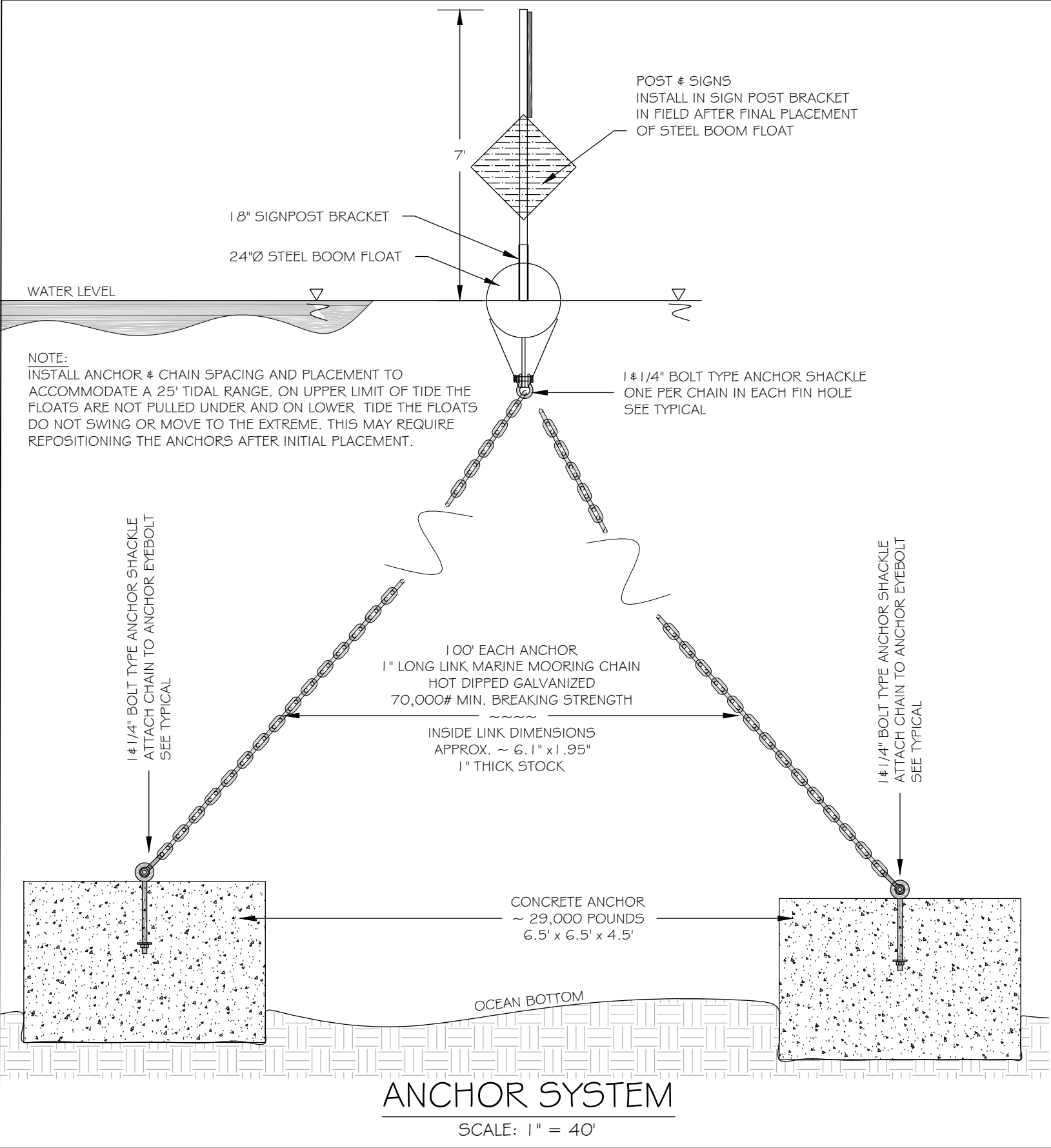

DEMOLITION
EXISTING STEEL BOOM FLOAT PLAN
SCALE: 1" = 80'

EXISTING STEEL BOOM FLOAT
APPROXIMATE LOCATIONS

- BOOM #1. FLOATING OFF OF BANANA POINT (B.P.) BOAT RAMP
BOOM #2. HIGH TIDE LINE & TIED TO TREE ABOUT 100 YARDS NW OF B.P. BOAT RAMP
BOOM #3. WILSON CREEK CAMP GROUND - HIGH TIDE LINE & TIED TO TREE ABOUT 6/10 MILE WEST OF B.P. BOAT RAMP
BOOM #4. STATION ISLAND, WEST OF BLIND SLOUGH - HIGH TIDE LINE & TIED TO TREE ABOUT 7 MILES SW OF B.P. BOAT RAMP

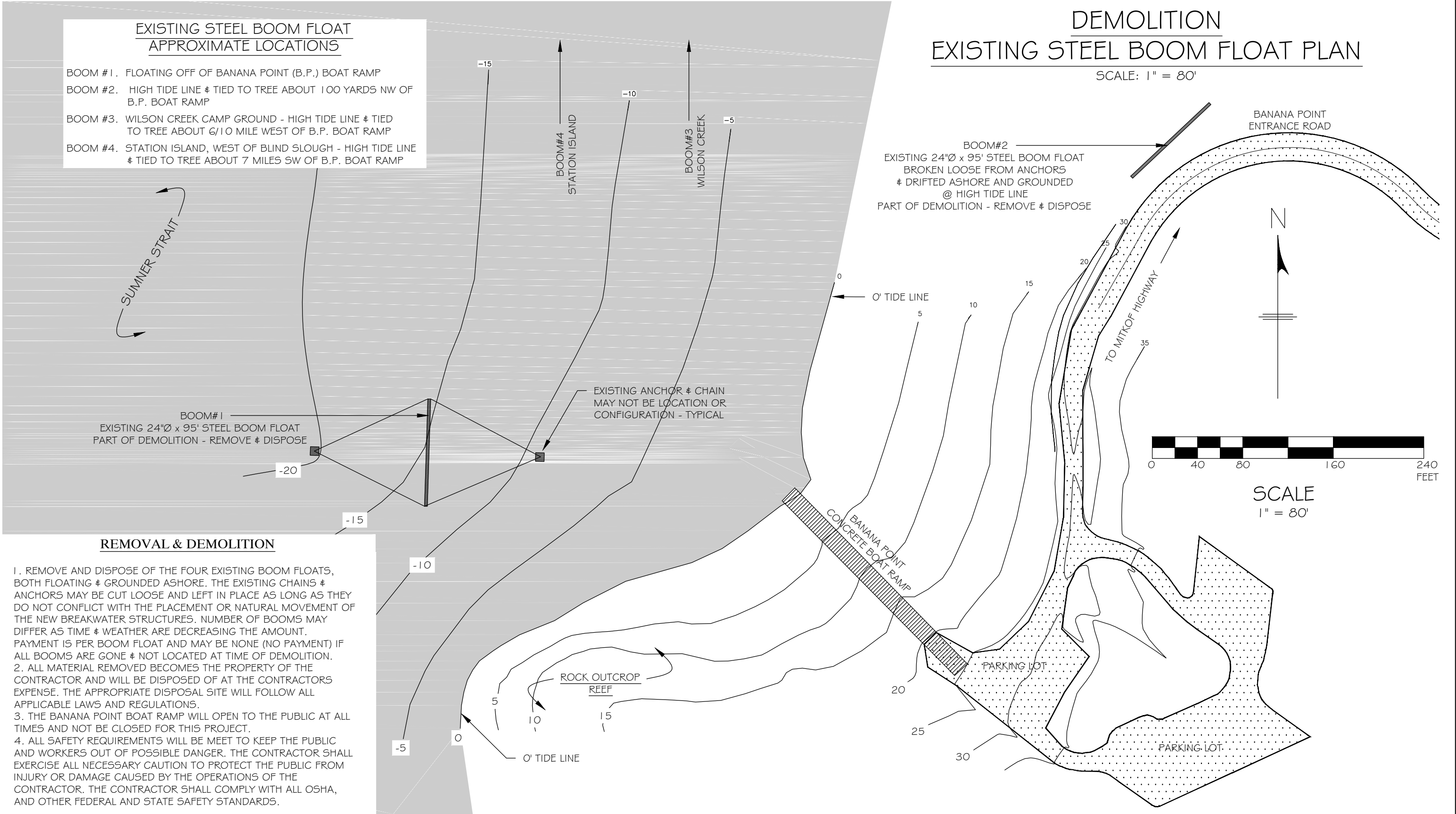

REMOVAL & DEMOLITION

1. REMOVE AND DISPOSE OF THE FOUR EXISTING BOOM FLOATS, BOTH FLOATING & GROUNDED ASHORE. THE EXISTING CHAINS & ANCHORS MAY BE CUT LOOSE AND LEFT IN PLACE AS LONG AS THEY DO NOT CONFLICT WITH THE PLACEMENT OR NATURAL MOVEMENT OF THE NEW BREAKWATER STRUCTURES. NUMBER OF BOOMS MAY DIFFER AS TIME & WEATHER ARE DECREASING THE AMOUNT. PAYMENT IS PER BOOM FLOAT AND MAY BE NONE (NO PAYMENT) IF ALL BOOMS ARE GONE & NOT LOCATED AT TIME OF DEMOLITION.
2. ALL MATERIAL REMOVED BECOMES THE PROPERTY OF THE CONTRACTOR AND WILL BE DISPOSED OF AT THE CONTRACTORS EXPENSE. THE APPROPRIATE DISPOSAL SITE WILL FOLLOW ALL APPLICABLE LAWS AND REGULATIONS.
3. THE BANANA POINT BOAT RAMP WILL OPEN TO THE PUBLIC AT ALL TIMES AND NOT BE CLOSED FOR THIS PROJECT.
4. ALL SAFETY REQUIREMENTS WILL BE MEET TO KEEP THE PUBLIC AND WORKERS OUT OF POSSIBLE DANGER. THE CONTRACTOR SHALL EXERCISE ALL NECESSARY CAUTION TO PROTECT THE PUBLIC FROM INJURY OR DAMAGE CAUSED BY THE OPERATIONS OF THE CONTRACTOR. THE CONTRACTOR SHALL COMPLY WITH ALL OSHA, AND OTHER FEDERAL AND STATE SAFETY STANDARDS.

REMOVAL &
DEMOLITION
OF EXISTING
FLOATS

BANANA POINT BREAKWATER
IMPROVEMENTS

PETERSBURG BOROUGH
PETERSBURG, ALASKA

REVISIONS		
REV	DATE	DESCRIPTION

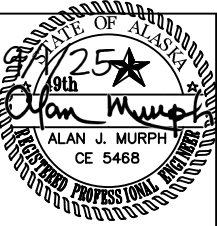

DESIGNED BY:
HARAI & ASSOCIATES, INC
P.O. BOX 625, PETERSBURG, ALASKA 99833
DATE: JULY 2025
SHEET NUMBER
5
OF 5